

## The Factory-Assembled, Drop-In Replacement

The original oil filter housings on the Pentastar V6 are known for their high failure rates. There are multiple weak points in the original design where oil can leak. Our engineers evaluated the original units and designed housings with multiple improvements over the original to address the OE weak points while matching thermal characteristics.

### Completed assembled for easy installation and design improvements to prevent oil leaks

Inside the GP Sorensen® box, you'll find an Oil Filter Housing Kit that is already assembled from the factory. Our assemblies include new oil pressure sensors, oil temperature sensors, oil coolers, correct year/make/model-specific oil filters and new gaskets and seals already installed. Our Oil Filter Housing Kits also include the intake manifold gaskets needed for a complete repair.



# NO ASSEMBLY REQUIRED

Factory-assembled,  
drop-in replacement

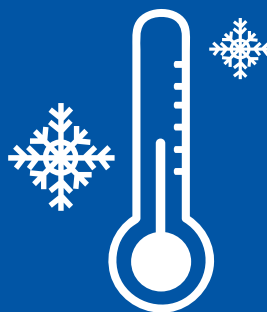

Designed with a high-strength, high-temp  
synthetic housing to maintain  
OE-matching thermal characteristics



Our engineers identify weak points  
in the original units and design  
improvements to address them

## GP Sorensen® Oil Filter Housing Kits feature improvements over the OE

### OE Problem:

Oil leaks from the brass sensor inserts because there is not an effective seal between the brass and the synthetic housing material.

### GP Sorensen® Solution:

Additional O-rings are installed on our knurled brass inserts to prevent oil leaks.

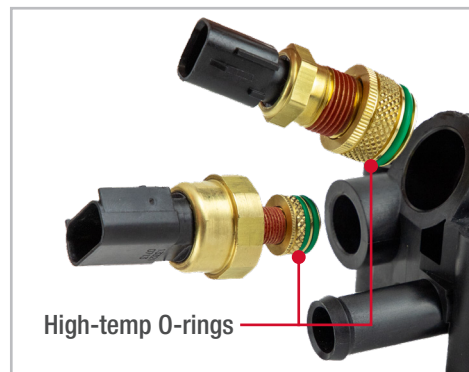

### OE Problem:

Oil leaks from the back of the housing around the core plugs that are installed without any seals or O-rings.

### GP Sorensen® Solution:

GP Sorensen® installs an O-ring on each core plug before ultrasonically welding them into the housing. This creates a positive, long-lasting seal.

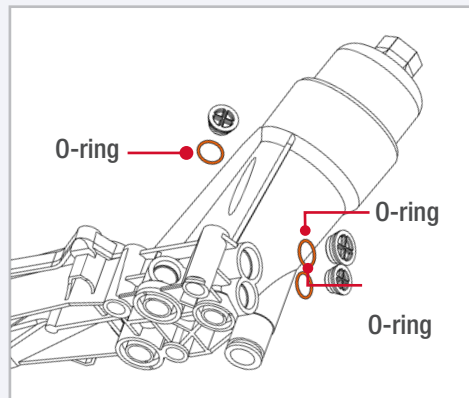

### OE Problem:

Oil contaminates the coolant causing cooling system problems, resulting in overheating and premature radiator failure. This is because there is no seal on the core plug that separates the oil and coolant passages.

### GP Sorensen® Solution:

We added a robust seal to the core plug which separates these two passages. This enhancement prevents an internal failure and cross-contamination.

